

Address

390 West Bay Road, KY1-1203 George Town,
Grand Cayman, Cayman Islands,

Contact

+1 345 949 3521
info@bhhs caymanislands.com

SELWORTHY GROVE CAYMAN BRAC LAND LOT

Cayman Brac East, Cayman Islands

PROPERTY DETAILS

Price: US\$42,000	MLS#: 416482	Type: Land
Listing Type: Little Cayman/Cayman Brac	Status: Current	Width: 99.81
Depth: 108.01	Built: 0	Acres: 0.2461

PROPERTY DESCRIPTION

Embrace the extraordinary prospect of acquiring a captivating residential parcel within the esteemed Selworthy Grove Development, gracefully positioned in the awe-inspiring landscape of Cayman Brac. Spanning across 0.2461 acres, this expansive land expanse offers a pristine canvas on which to curate your personalized dwelling, finely tuned to your discerning preferences and lifestyle aspirations. Whether you envision an opulent haven or an intimate familial abode, this property extends itself as the quintessential foundation upon which your architectural dreams can flourish. Enthroned upon the Cayman Brac bluff, the property elevates itself to an impressive 82 feet above sea level, conferring upon its fortunate owner panoramic vistas that are simply breathtaking. Visualize awakening each dawn to the gentle caress of the tropical breeze and the verdant panoramas. The Selworthy Grove Development epitomizes opulent living, providing tranquil and exclusive surroundings in which residents can savor life's finer pleasures. An interesting highlight lies in the envisioned addition of a shared tennis court seamlessly integrated into the community, creating a hub for friendly matches or the invigorating pursuit of physical activity. Whether you're a seasoned expert or a budding enthusiast, this amenity adds an extra dimension of leisure and recreation to enrich your way of life. This acquisition extends beyond securing a slice of paradise; it bestows the prospect of a shrewd and potentially profitable asset. Renowned as a sought-after investment haven, the Cayman Islands boast a robust real estate domain, underscored by stability and prosperous expansion. As a proprietor of this prime residential parcel, you stand poised to leverage the island's thriving tourism industry, reaping the fiscal rewards inherent in your investment. Elevate your potential by contacting me for more information and seize this golden occasion without delay. The opportunity to forge you... [View More](#)

PROPERTY FEATURES

Views	Garden View
Block	110A
Parcel	216
Road Frontage	99.81

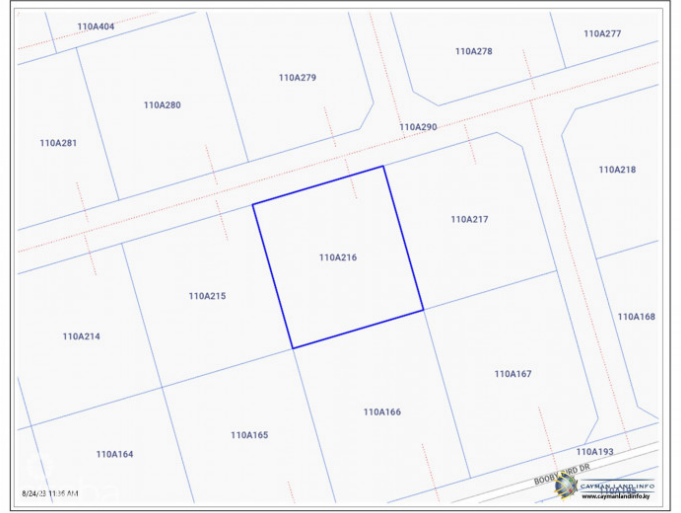

CIREBA MLS LDX feed courtesy of WILLIAMS2 REAL ESTATE

***Disclaimer:** The information contained herein has been furnished by the owner(s) and or their nominee and represented by them to be accurate. The listing company, agent and CIREBA MLS disclaims any liability or responsibility for any inaccuracies, errors or omissions in the represented information. The listing details herein are also courtesy of CIREBA (Cayman Islands Real Estate Brokers Association) MLS and/or via LDX (Listing Data Exchange) feed. All the information contained herein is subject to errors, omissions, price changes, prior sale or withdrawal, without notice and is at all times subject to verification by the purchaser(s).