

Address

390 West Bay Road, KY1-1203 George Town,
Grand Cayman, Cayman Islands,

Contact

+1 345 949 3521
info@bhhs Cayman Islands.com

CAYMAN BRAC PARCEL 215 & 216 BUNDLE

Cayman Brac East, Cayman Islands

PROPERTY DETAILS

Price: US\$80,000	MLS#: 416521	Type: Land
Listing Type: Little Cayman/Cayman Brac	Status: Current	Width: 200.94
Depth: 107.18	Built: 0	Acres: 0.4923

PROPERTY DESCRIPTION

Envision owning not just one, but two exceptional parcels of land within the prestigious Selworthy Grove Development, cradled amid the captivating vistas of Cayman Brac. This remarkable offering opens the door to crafting not one, but two dream homes. With each plot spanning 0.2450 acres with a combined total of .4923 acres, you're afforded abundant space to fashion residences that mirror your unique lifestyle and preferences. The allure of these properties is elevated by their perch atop the Cayman Brac bluff, rising a commanding 82 feet above the azure sea. This elevated vantage promises expansive, awe-inspiring views of the natural splendor that envelops the area. Imagine waking up to caressing island breezes, greeted by the lush tapestry of the tropics. The Selworthy Grove Development is planning a communal tennis court, poised to enrich the lives of residents with leisurely matches and the chance to partake in physical activities, regardless of whether they're seasoned players or enthusiastic beginners. But these plots hold more than the promise of paradise - they represent an avenue to secure potentially lucrative assets. The Cayman Islands' robust real estate market and reputation for stability and growth have long captivated investors. By becoming stewards of these prime residential lands, you position yourself to capitalize on the flourishing tourism industry and the financial benefits it presents. For a deeper dive into this extraordinary opportunity and to grasp the golden prospects at hand, don't hesitate to contact us. The chance to actualize your visions within the Selworthy Grove Development on Cayman Brac is now doubly present. Seize this moment to invest in a future that's entirely your own, embrace the epitome of opulent living, and immerse yourself in the untamed beauty of the Caribbean paradise that beckons. Call today for a private tour. How do you want to live your life? PICS- Source: www.caymanlandinfo.ky

PROPERTY FEATURES

Views	Garden View
Block	110A
Parcel	215, 216
Road Frontage	200.9

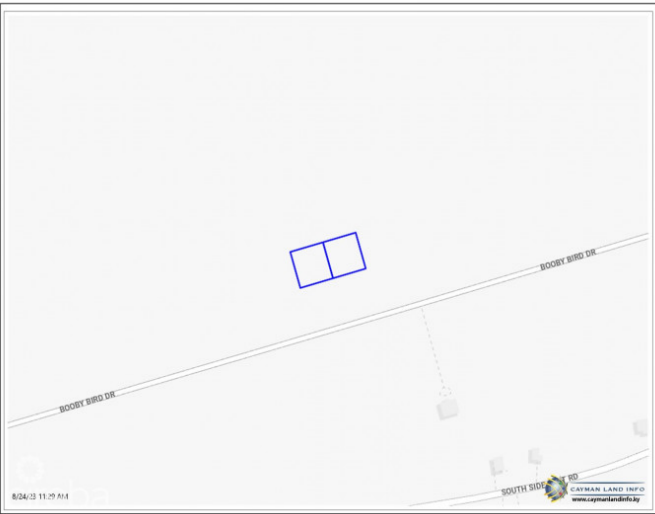
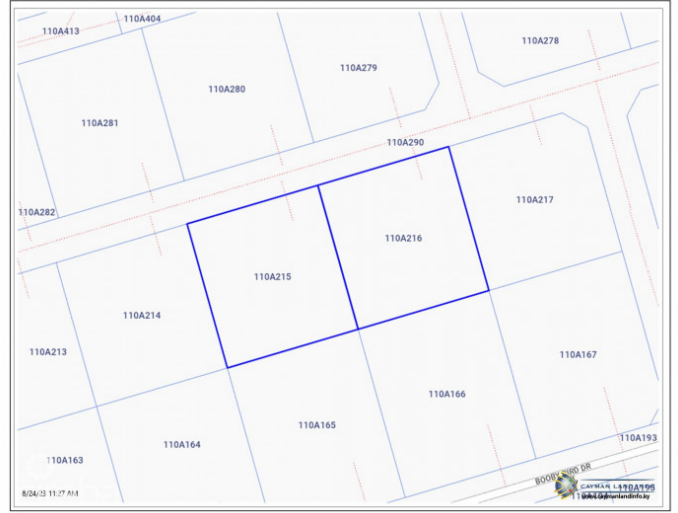

CIREBA MLS LDX feed courtesy of WILLIAMS2 REAL ESTATE

***Disclaimer:** The information contained herein has been furnished by the owner(s) and or their nominee and represented by them to be accurate. The listing company, agent and CIREBA MLS disclaims any liability or responsibility for any inaccuracies, errors or omissions in the represented information. The listing details herein are also courtesy of CIREBA (Cayman Islands Real Estate Brokers Association) MLS and/or via LDX (Listing Data Exchange) feed. All the information contained herein is subject to errors, omissions, price changes, prior sale or withdrawal, without notice and is at all times subject to verification by the purchaser(s).