

**EAST END LAND**

East End, Cayman Islands

**PROPERTY DETAILS**

Price: CI\$75,000	MLS#: 412307	Type: Land
Listing Type: Agriculture	Status: Current	Width: 125
Depth: 82	Built: 0	Acres: 0.2394

**PROPERTY DESCRIPTION**

Land bank in the quiet side of Cayman. Nice size lot near the village of East End! There is a 'six foot right of way' to this land and a 30 foot road access is in place but the adjoining neighbors will need to share the cost of building the road. elevation is 8 feet

**PROPERTY FEATURES**

Views	Garden View
Block	75A
Parcel	354
Zoning	Agriculture/Residential
Road Frontage	125
Soil	Marl

**IMAGES**

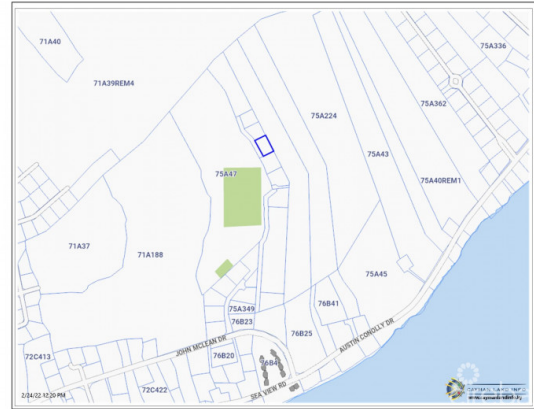

---

CIREBA MLS LDX feed courtesy of ENGEL & VOLKERS

**\*Disclaimer:** The information contained herein has been furnished by the owner(s) and or their nominee and represented by them to be accurate. The listing company, agent and CIREBA MLS disclaims any liability or responsibility for any inaccuracies, errors or omissions in the represented information. The listing details herein are also courtesy of CIREBA (Cayman Islands Real Estate Brokers Association) MLS and/or via LDX (Listing Data Exchange) feed. All the information contained herein is subject to errors, omissions, price changes, prior sale or withdrawal, without notice and is at all times subject to verification by the purchaser(s).