

**Address**

390 West Bay Road, KY1-1203 George Town,  
Grand Cayman, Cayman Islands,

**Contact**

+1 345 949 3521  
info@bhhs Cayman Islands.com

---

## AIRPORT INDUSTRIAL LAND

George Town, Cayman Islands

### PROPERTY DETAILS

---

Price: CI\$1,095,000	MLS#: 418619	Type: Land
Listing Type: Industrial	Status: Current	Width: 170
Depth: 108	Built: 0	Acres: 0.37

### PROPERTY DESCRIPTION

---

A Strategic Opportunity in the Heart of Grand Cayman: Positioned just steps from Owen Roberts International Airport on Breezy Way, this 0.3699-acre parcel is perfectly located to support business ventures or long-term investments. With its light industrial zoning and convenient 30-foot vehicular right of way, this property offers immense versatility for future development. Designed for Success and Growth: This filled and level lot ensures a smooth start for construction projects. Zoned for light industrial use, it opens the door to a variety of possibilities, from logistics and warehousing to office spaces catering to businesses that benefit from proximity to the airport. Its location near Grand Cayman's growing international airport makes it a valuable asset for companies requiring efficient connections to global markets. Capitalize on Expansion Potential: This property holds significant promise as Grand Cayman's infrastructure continues to expand. Its location places it in the spotlight of future airport growth, making it a smart, forward-looking investment. Whether you're establishing a business or seeking a high-potential asset, this parcel ensures excellent value. Highlights of the Property: Proximity to Owen Roberts International Airport for unmatched accessibility. Light industrial zoning, offering flexibility for various business purposes. 30-foot vehicular right of way, ensuring easy logistics and access. Filled, level topography, ready for development. A secure investment in one of Grand Cayman's most strategic commercial areas. Your Gateway to Growth: Light industrial zoning in Grand Cayman allows for warehouses, light manufacturing, workshops, storage, utilities, and supporting commercial uses. Developments must comply with regulations on height, setbacks, parking, and environmental standards. Conditional uses may include recycling or caretaker housing, subject to Central Planning Authority approval. Consult Planning for s... [View More](#)

### PROPERTY FEATURES

---

Views	Garden View
Block	20C
Parcel	71
Zoning	Light Industrial
Road Frontage	Close
Soil	Marl

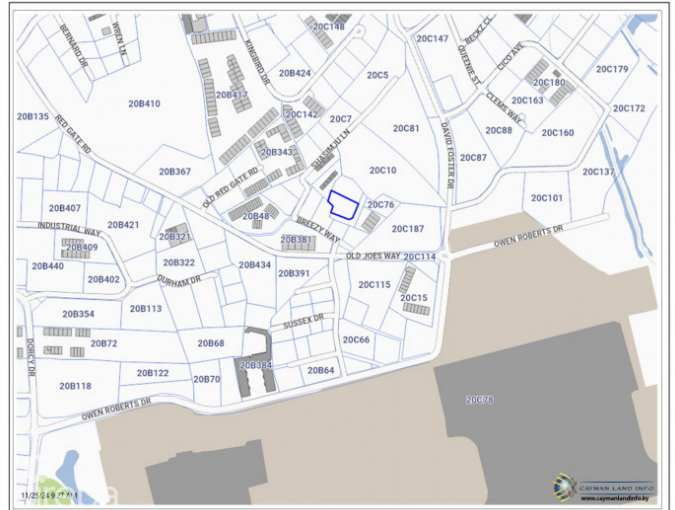

CIREBA MLS LDX feed courtesy of WILLIAMS2 REAL ESTATE

**\*Disclaimer:** The information contained herein has been furnished by the owner(s) and or their nominee and represented by them to be accurate. The listing company, agent and CIREBA MLS disclaims any liability or responsibility for any inaccuracies, errors or omissions in the represented information. The listing details herein are also courtesy of CIREBA (Cayman Islands Real Estate Brokers Association) MLS and/or via LDX (Listing Data Exchange) feed. All the information contained herein is subject to errors, omissions, price changes, prior sale or withdrawal, without notice and is at all times subject to verification by the purchaser(s).